

MD11C

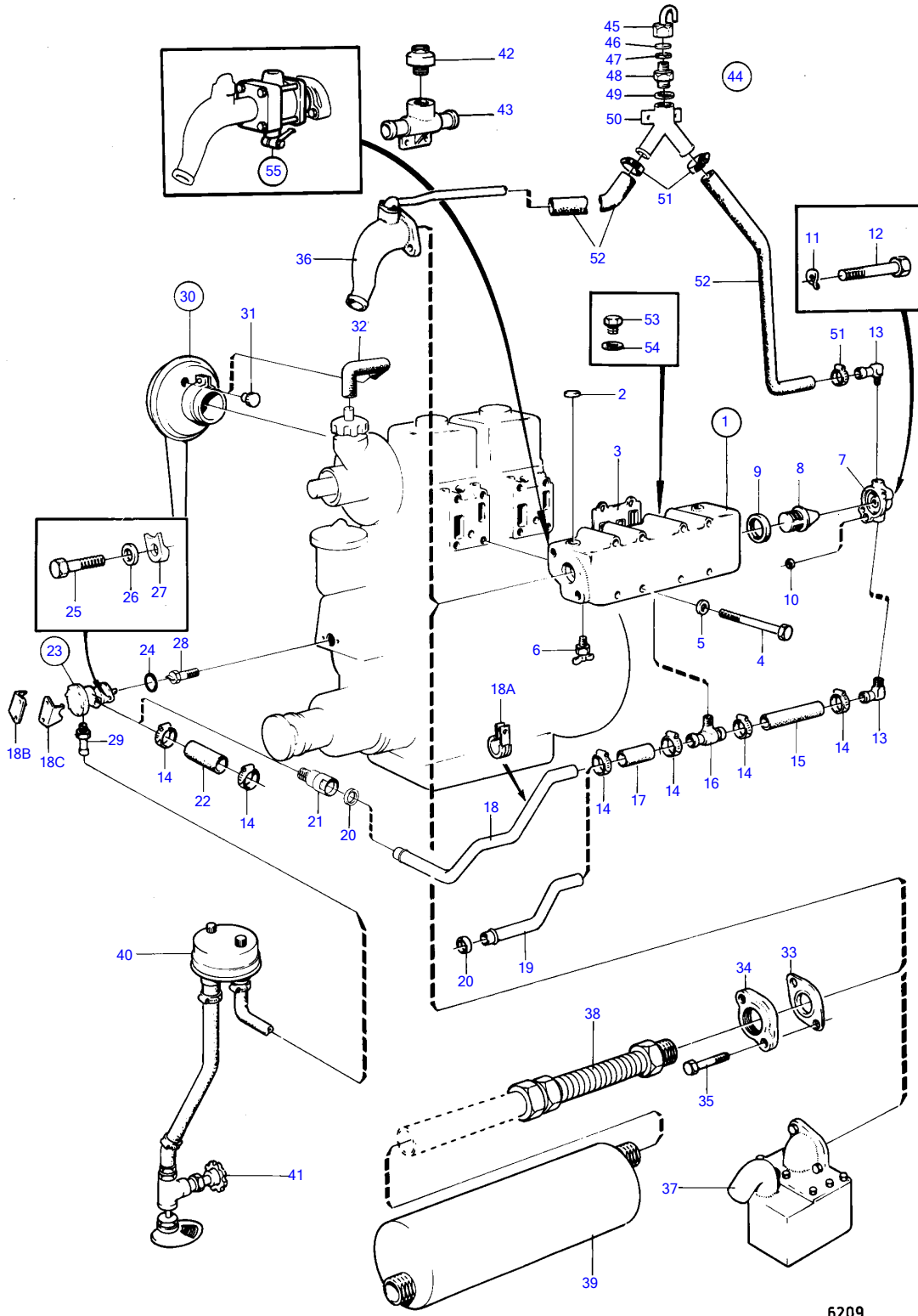

6209

MD11C

REF	PART NO.	QTY	DESCRIPTION	SEE SEC.	NOTES
1		1	EXHAUST MANIFOLD		REPLACED BY 829930., MO-51593
	829930	1	Exhaust pipe		MO 51594-
2	192211	3	• Expansion plug		
3	833598	2	Gasket		
4	940129	8	Hexagon screw		
5	955894	8	Washer		
6	829592	1	Drain cock		
7	833412	1	Thermostat housing		OBSOLETE PART
8	829812	1	Thermostat		62°C
9	416033	1	Sealing ring		(418361) MO-50675
	416033	1	Sealing ring		MO 50676-
10	955989	1	O-ring		
11	941907	2	Spring washer		
12	955299	2	Hexagon screw		
13	801197	2	Hose attachment		
14	943472	6	Hose clamp		
15	952969	X	Hose		L = 145 MM
16	833356	1	Hose attachment		OBSOLETE PART
17	952969	X	Hose		L = 50 MM
18	829687	1	Water pipe		MD11C, MD11/HD-BT, MD11C/HD-RB, MO 38447-38450, 38871-. MD11C/100S, MD11C/110S., OBSOLETE PART
19	833517	1	Tube		MD11C/HY, MD11/HD-HY, OBSOLETE PART
20	418411	1	Sealing ring		MD11C, MD11/HD-BT, MD11C/HD-RB, MO 38447-38450, 38871-. MD11C/100S, MD11C/110S.
21	833969	1	Insert nipple		MD11C, MD11/HD-BT, MD11C/HD-RB, MO 38447-38450, 38871-. MD11C/100S, MD11C/110S., OBSOLETE PART
22	952969	X	Hose		MD11C/HY, MD11/HD-HY, L = 100 MM
23	833883	1	Water pump		
			•	15111	
	833522	1	Water pump		MD11C/HY, MD11/HD-HY
			•	15111	
			•	15113	
24	955998	1	O-ring		MD11C, MD11/HD-BT, MD11C/HD-RB, MO 38447-38450, 38871-. MD11C/100S, MD11C/110S.
	802551	1	Gasket		MD11C/HY, MD11/HD-HY
25	955296	2	Hexagon screw		
26	941907	2	Spring washer		MD11C, MD11/HD-BT, MD11C/HD-RB, MO 38447-38450, 38871-. MD11C/100S, MD11C/110S.
	11992	2	Gasket		MD11C/HY, MD11/HD-HY
27	833878	2	Clamp		
28	807031	1	Screw		SEE GROUP 2A, OBSOLETE PART
29	801197	1	Hose attachment		
30	833414	2	Air filter		OBSOLETE PART
31	833546	2	• Plug		
32	833468	1	Rubber hose		SEE GROUP 2A, OBSOLETE PART
33	803374	1	Gasket		
34	807050	1	Exhaust pipe flange		
	807050	1	Exhaust pipe flange		SPEC 867420, 867351., MO-49894
35	955319	2	Hexagon screw		
	955319	2	Hexagon screw		SPEC 867420, 867351., MO-49894
36	833585	1	Riser		SEE GROUP 9, OBSOLETE PART
	833998	1	Exhaust riser		MD11C/HD-RB, MD11C/HD-BT, MD11C/HD-HY., SEE GROUP 9
	833583	1	Exhaust riser, WATER COOLED EXHAUST BEND		SPEC 867498, 867499., MO 49895-
			•	15108	
37	833684	1	Muffler, WET		SEE GROUP 9, EARLY TYPE, OBSOLETE PART
	828064	1	Muffler		SEE GROUP 9, LATE TYPE

7742230-26-15106

6209

Upd:2010-07-01

MD11, MD11C, MD11D, MD17, MD17C, MD17D



MD11C

REF	PART NO.	QTY	DESCRIPTION	SEE SEC.	NOTES
38	833841	1	Compensator		DRY EXHAUST LINE., OBSOLETE PART
39	833840	1	Muffler, DRY		
40	831733	1	Strainer		SEE GROUP 9
41	828242	1	Cooling water inlet		SEE GROUP 9
42		1	VACUUM VALVE		REPLACED BY 828263, 828262., EARLY TYPE
43		1	HOUSING		REPLACED BY 828263, 828262., EARLY TYPE
44	828534	1	Vacuum valve		(828263)
45		1	• UPPER UNIT		
46		2	• Diaphragm		
47	828424	2	• Gasket		
48		1	• LOWER PART		
49	947282	2	• Gasket		
50	828262	1	Hose connection		LATE TYPE
51	961666	4	Hose clamp		
52	13569	X	Hose		
53	960630	1	Plug		FOR EXHAUST MANIFOLD 829930.
54	957178	1	Gasket		FOR EXHAUST MANIFOLD 829930.
55	829986	1	Exhaust brake, EXHAUST PRESSURE REGULATOR KIT		SPEC 867351, 867374, MO47277-., SEE GROUP 9, OBSOLETE PART
			EXHAUST PRESSURE REGULATOR AND CONTROLS		SPEC 867374, 867499., SEE GROUP 2D